

WHY ARE BEST MANAGEMENT PRACTICES (BMPs) IMPORTANT?

BMPs are enforceable procedures, based on regulations, that minimize pollutants that are discharged to the sewer system or the environment. BMPs are needed at both industrial and commercial facilities that can produce wastewater containing higher levels of pollutants than what are typically found in residential wastewater.

REQUIREMENTS

COMPLIANCE WITH LOCAL CODES

- ◇ All auto repair operations that send wastewater to the sewer system must ensure their wastewater complies with all local codes and requirements.

APPLY FOR A PERMIT IF NEEDED

- ◇ Auto repair shops must apply for a permit if they discharge over 25,000 gallons a day.

CONTACT US



City of Spokane
(509) 625-4600



Spokane County
(509) 477-7177



Airway Heights
(509) 443-5667

ADDITIONAL RESOURCES

HAZARDOUS WASTE HANDLING:

Department of Ecology
(509) 329-3400
www.ecy.wa.gov

Spokane Regional Health District
(509) 324-1560 ext. 3
www.srhd.org

For hazardous spills or any other emergencies, call 911

July 24, 2023

COMMERCIAL AUTO REPAIR OPERATIONS



COMMERCIAL WASTEWATER BEST MANAGEMENT PRACTICES (BMPs)

AUTO REPAIR SHOP BMPs

- ◇ Determine whether each waste material is hazardous using the guidelines in WAC 173-303-9903 and WAC 173-303-9904.
- ◇ Post signs above drains/sinks prohibiting the discharge of chemicals and oils.
- ◇ Make sure wash water does not run into the gutter or storm drain.
- ◇ Develop a written spill response plan, keep spill clean-up materials on site, immediately clean up any spills, train employees on clean up procedures, and replace leaking containers.
- ◇ Install secondary containment for all liquid storage capable of containing 110% of the largest possible spill.

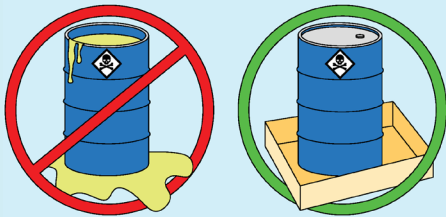

- ◇ Never allow wash water or any other liquids to enter the street, gutter, storm drains, or dry wells.

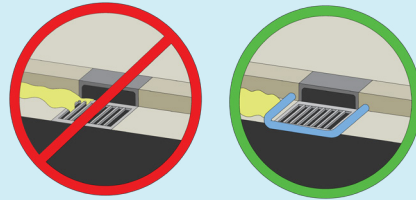

- ◇ Store batteries, chemicals, and all wastes where they will not be exposed to rainwater.



- ◇ Storage and waste containers should have clear labels indicating their contents.
- ◇ Dry sweep floors before mopping or hosing down.
- ◇ For oil-water separators, follow an inspection schedule, contract with a hazardous waste disposal company for cleanouts, and retain maintenance records. Visit www.spokanecounty.org/FOG for more information.
- ◇ Immediately clean up any spills and replace any leaking containers.

POLLUTION PREVENTION TIPS

These tips are not enforceable, but will help your business reduce its impact on the environment.

- ◇ Develop and follow a written Environmental Management Plan, periodically inspecting and repairing equipment.
- ◇ Use spigots, pumps, and funnels when pouring solvents, cleaners, and other chemicals.
- ◇ Drain oil filters for 24 hours before disposing in the trash.
- ◇ Antifreeze should be recycled. Ethylene glycol and propylene glycol should be stored and recycled separately. For more information, search the Dept. of Ecology website (www.ecy.wa.gov) for "antifreeze."
- ◇ Used motor oil, brake fluid, transmission fluid, lubricating oil, compressor oil, gear, and metalworking fluid without chlorinated compounds are all considered used motor oil and can be mixed. If used motor oil is recycled, the used motor oil is not considered hazardous waste.